

## CLASSE H4 BORDO PONTE - BARRIERA 3 ONDE PER MANUFATTO W8 CON PANNELLO RETE

Class H4 Bridge side - 3-waves guardrail for bridge W8 with mesh panel

3 Wellen Leitplanke auf Bauwerk, Aufhaltestufe H4, Wirkungsbereich W8 mit Panel-Netzwerk

Classe H4 Bord pont - Glissière 3 ondes simple pour pont W8 avec panneau de réseau

Clase H4 Borde de puente - Barrera de triple onda simple para base puente W8 con panel del malla electrosoldada

**Rete Mesh panel • H 1,5 - 2 - 2,5 - 3 - 3,5 m**

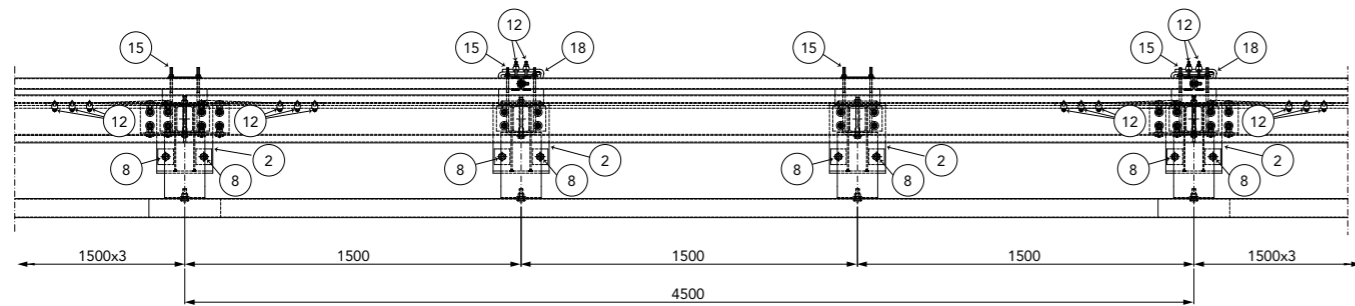
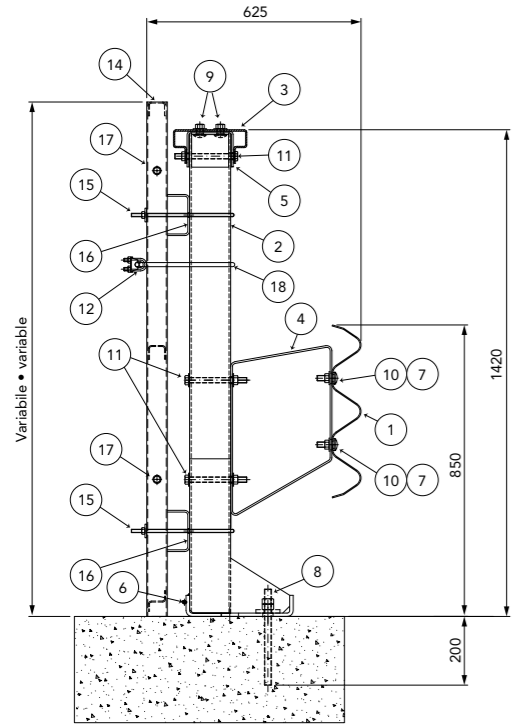

Rapporti di prova Crash test reports, Testberichte, Comptes rendus d'essais, Relaciones de pruebas

Test n.	Facility	Test	Type	Barrier length MTL	Mass kg	Speed km/h	ASI max 1.4	THIV max 33 km/h	D m	Vi m	W m
PROVA 1034	Aisico	TB81	Laterale 20°	78	38.000	65	-	-	0,8	1,6	4,00=W8
PROVA 877	Aisico	TB11	Laterale 20°	86,5	900	100	1,1=B	27	0,4	-	0,6=W1

# H4-W8

## 3-waves WMP

RETE + LAMIERA • MESH PANEL + SHEET

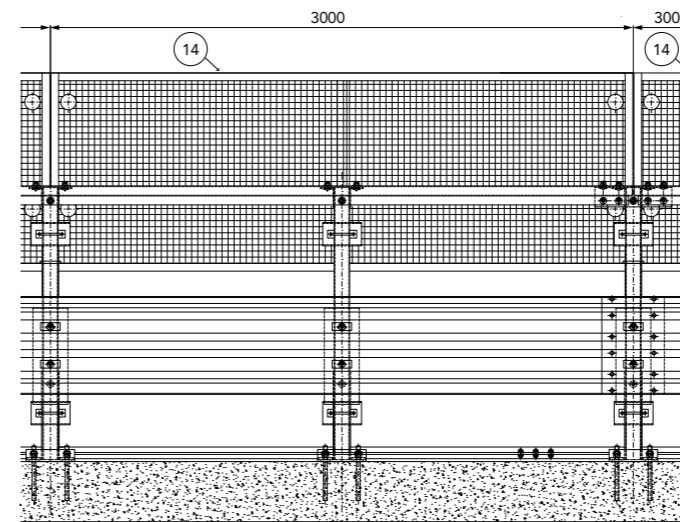

RETE • MESH PANEL

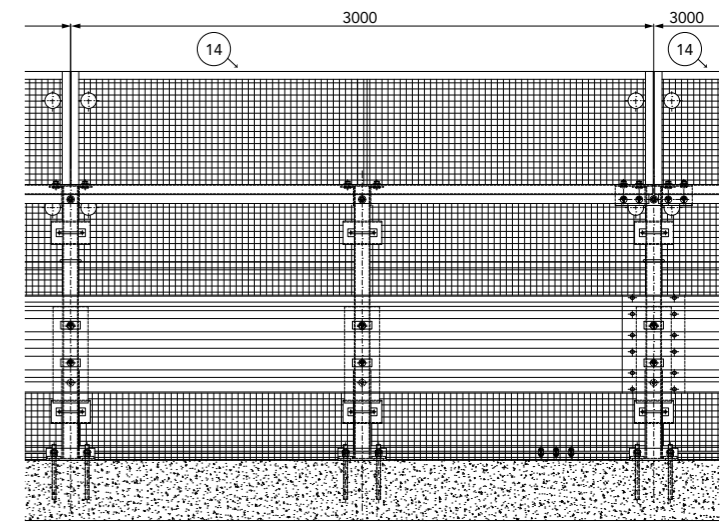

Caratteristiche rete Mesh characteristics

CE	Altezza Height, Höhe, Hauteur, Altura	Rete Mesh
403 M4	1,5 m	30x30x3
403		30x30x3
403 MA		30x30x3 + lamiera (sheet)
403 MB		50x50x3
403 MC		50x50x3 + lamiera (sheet)
403 M2	2 m	30x30x3
403 M2A		30x30x3 + lamiera (sheet)
403 M2B		50x50x3
403 M2C		50x50x3 + lamiera (sheet)
403 M1		30x30x3
403 M1A	3 m (2 + 1 m)	30x30x3 + lamiera (sheet)
403 M1B		50x50x3
403 M1C		50x50x3 + lamiera (sheet)
403 M3	3,5 m (2 + 1,5 m)	30x30x3
403 M3A		30x30x3 + lamiera (sheet)
403 M3B		50x50x3
403 M3C		50x50x3 + lamiera (sheet)